

TCL 3850 & 3852 Series

**FULLY FLUSH TAXIWAY CENTERLINE
AND CLEARANCE BAR LIGHT**

L852A & L852C



3850 Bi-Directional

The 3850 and 3852 Fully Flush Taxiway Centerline and Clearance Bar Lights are used on Category I, II, & III taxiways. The 3850 is a bi-directional fixture for taxiway straight sections. The 3852 is a unidirectional fixture for high-speed turn offs and clearance bar applications.

Un-like other fixtures the 3850 and 3852 are fully flush with absolutely no protrusion above the taxiway surface. This feature virtually eliminates damage to fixtures by snowplows and greatly increases the speed at which runways can be cleared.



3852 Unidirectional

The 3850 and 3852 can be configured with yellow and green dichroic prisms meeting the L-852A and L-852C requirements of FAA AC 150/5345-46. Other options available include red and white light patterns.

The standard 3850 & 3852 fixture is equipped with a single standard L823 Plug with 18inch leads. Dual plugs for individual light control are also available. Dual 30W or 45W 1,000 Hour Life Lamps are available for each fixture.

Technical Specifications

Specifications	FAA AC 150/5345-46 – ETL Verified ICAO Annex 14
Input:	6.6A through a 100W Isolation Transformer
Lamp:	Dual 1,000 Hour 30W or 45W Lamps
Colors:	Clear (White) or Dichroic Green, Yellow or Red Prisms
Mounting:	305mm (12 in.) L868 size B deep base set 19mm (3/4 in.) below grade. Attached using 6 bolts on a 286mm (11 1/4 in.) diameter bolt circle.
Temperature:	-55°C to +55°C (-67°F to +131°F)



Multi

ELECTRIC

The Quality Approach

ORDERING INFORMATION

3 8 5 X - X X - X

Basic Light Fixture

Direction: Bi-directional = 0
Unidirectional = 2

Color: White = W
Green = G
Red = R
Yellow = A

Lamp: 30W Quartz 6.6A MR16 = 1
45W Quartz 6.6A MR16 = 2

Example: 1) A bi-directional 45W Amber-Green fixture order 3850-AG-2
2) Unidirectional 30W Green order 3852-GG-1

REPLACEMENT PARTS

<u>Part No</u>	<u>Description</u>	<u>Part No</u>	<u>Description</u>
3850 - 04	PLATE, Prism, taxiway light fixture, flush, bi-directional	3850 - 15	O RING, Gasket
3850 - 05	GASKET, Prism, taxiway light fixture, flush, bi-directional	3852 - 04	PLATE, Prism, taxiway light fixture, flush, unidirectional
3850 - 6G	PRISM, Dichroic Green	3852 - 05	GASKET, Prism, taxiway light fixture, flush, unidirectional
3850 - 6A	PRISM, Dichroic Amber (yellow)	3852 - 10	GASKET, Cork, taxiway light fixture, flush, unidirectional
3850 - 10	GASKET, Cork, taxiway light fixture, flush, bi-directional	3852 - 12	CASTING ASSY, Upper, taxiway light fixture, flush, unidirectional
3850 - 11	LAMP BRACKET ASSY, taxiway light fixture, flush	3852 - 13	CASTING ASSY, Lower, taxiway light fixture, flush, unidirectional
3850 - 12	CASTING ASSY, Upper, taxiway light fixture, flush, bi-directional	9637 01	Lamp, 30W 6.6A MR16
3850 - 13	CASTING ASSY, Lower, taxiway light fixture, flush, bi-directional	9637 02	Lamp, 45W 6.6A MR16
3850 - 14	CABLE ASSY, Taxiway light fixture, flush	2856 - 33	Mounting Hardware Kit

Multi

ELECTRIC

The Quality Approach

BI-DIRECTIONAL FIXTURE

Model 3850

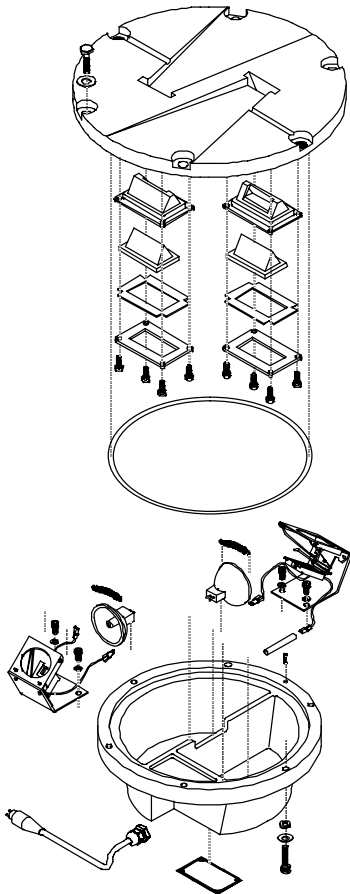

3850
Bidirectional Flush
Taxiway Fixture Assy

UNIDIRECTIONAL FIXTURE

Model 3852

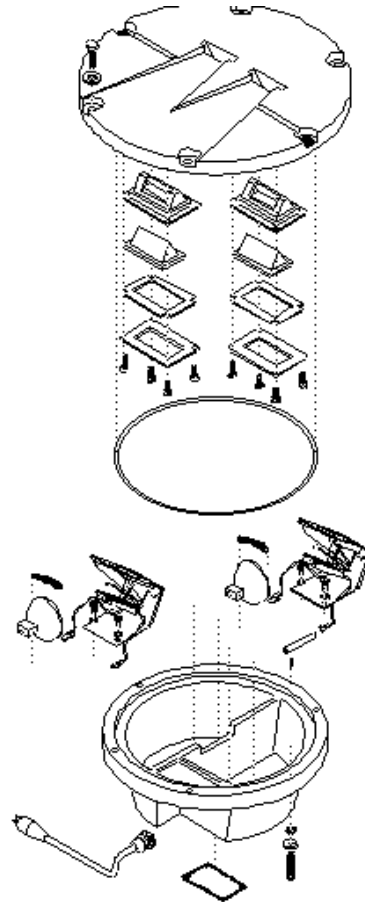

3852
Unidirectional Flush
Taxiway Fixture Assy

KEY FEATURES

- ✓ FULLY-FLUSH installation means no more damage to plow blades.
- ✓ Durable Non-Stick Finish on Top Casting for easy snow and ice removal.
- ✓ All components are FIELD replaceable insuring a long service life.
- ✓ Durable Cast Aluminum is used for a STRONG lightweight fixture.
- ✓ Optional clear white and red filtered light is available.
- ✓ Full 12-inch diameter to prevent the igloo effect of smaller fixtures.

L-852A Isocandela Curves

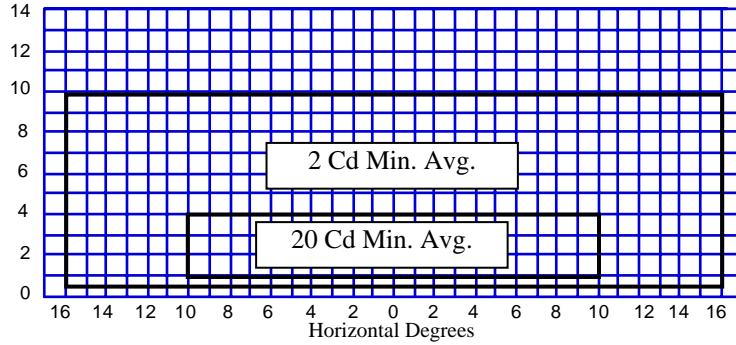

**For Taxiways with 1200
Foot RVR or greater**

Color: Green
Yellow
Green / Green
Yellow / Yellow
Green / Yellow

L-852C Isocandela Curves

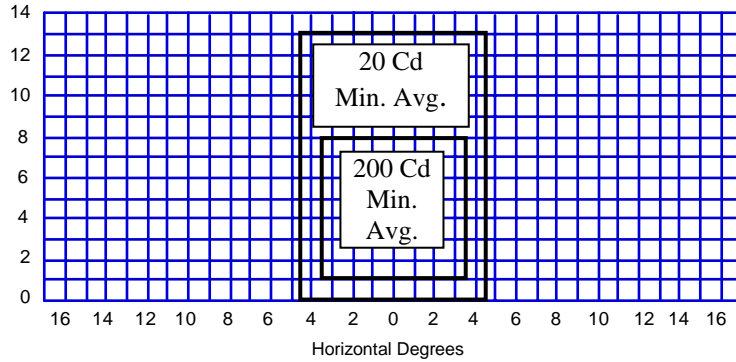

**For Taxiways with Less
Than 1200 Foot RVR**

Color: Green
Yellow
Green / Green
Yellow / Yellow
Green / Yellow

INSTALLATION

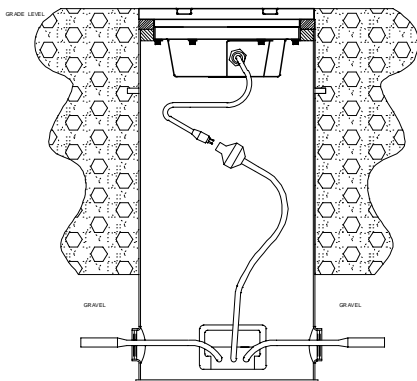

For Further Information Contact:

MULTI

Electric

4223 W Lake Street
Chicago, IL 60624
Tel: (773) 722-1900
Fax (773) 722-5694

Email: sales@multielectric.com
URL: www.multielectric.com